

# Seller's Property Disclosure

(To be completed by Seller)

This report supersedes any list appearing in the MLS

Property Address: 801 Foothill Dr

Hutchinson KS 67502

Seller: Edward J Forton & Mari Lynn Forton Date of Purchase: 08.15.2016

**Message to the Seller:** This statement is a disclosure of the condition of the above described Property known by the SELLER on the date that it is signed. It is not a warranty of any kind by the SELLER(S) or any real estate licensees involved in this transaction, and should not be accepted as a substitute for any inspections or warranties the BUYER(S) may wish to obtain. If you know something important about the Property that is not addressed on the Seller's Property Disclosure, add that information to the form. Prospective Buyers may rely on the information you provide.

**Instructions:** (1) Complete this form yourself. (2) Answer all questions truthfully and as fully as possible. (3) Attach all available supporting documentation. (4) Use explanation lines as necessary. (5) If you do not have the personal knowledge to answer a question, use the comment lines to explain.

**By signing below you acknowledge that the failure to disclose known material information about the Property may result in liability.**

**Message to the Buyer:** Although Seller's Property Disclosure is designed to assist the SELLER in disclosing all known material (important) facts about the Property, there are likely facts about the Property that the SELLER does not know. Therefore, it is important that you take an active role in obtaining the information about the Property.

**Instructions:** (1) Review this form and any attachments carefully. (2) Verify all important information. (3) Ask about any incomplete or inadequate responses. (4) Inquire about any concerns not addressed on the Seller's Property Disclosure. (5) Obtain professional inspections of the Property. (6) Investigate the surrounding area.

THE FOLLOWING ARE REPRESENTATIONS OF THE SELLER(S) AND ARE NOT INDEPENDENTLY VERIFIED BY THE BROKER(S) OR AGENTS(S).

## PART I

APPLIANCES					ELECTRICAL						
		TRANSFERS TO BUYER			Indicate the condition of the following items by marking only one appropriate box.			TRANSFERS TO BUYER			Indicate the condition of the following items by marking only one appropriate box.
None	Does Not Transfer	Working	Not Working	Don't Know		None	Does Not Transfer	Working	Not Working	Don't Know	
5	<input type="checkbox"/>	<input type="checkbox"/>	<input checked="" type="checkbox"/>	<input type="checkbox"/>	<input type="checkbox"/>	Disposal	<input type="checkbox"/>	<input type="checkbox"/>	<input checked="" type="checkbox"/>	<input type="checkbox"/>	Smoke/Fire Detectors
6	<input type="checkbox"/>	<input type="checkbox"/>	<input checked="" type="checkbox"/>	<input type="checkbox"/>	<input type="checkbox"/>	Dishwasher	<input type="checkbox"/>	<input type="checkbox"/>	<input checked="" type="checkbox"/>	<input type="checkbox"/>	Light Fixtures
7	<input type="checkbox"/>	<input type="checkbox"/>	<input checked="" type="checkbox"/>	<input type="checkbox"/>	<input type="checkbox"/>	Oven	<input type="checkbox"/>	<input type="checkbox"/>	<input checked="" type="checkbox"/>	<input type="checkbox"/>	Switches/Outlets
8	<input type="checkbox"/>	<input type="checkbox"/>	<input checked="" type="checkbox"/>	<input type="checkbox"/>	<input type="checkbox"/>	Range (Circle One) Gas <u>Electric</u>	<input type="checkbox"/>	<input type="checkbox"/>	<input checked="" type="checkbox"/>	<input type="checkbox"/>	Ceiling Fan(s)
9	<input type="checkbox"/>	<input type="checkbox"/>	<input checked="" type="checkbox"/>	<input type="checkbox"/>	<input type="checkbox"/>	Microwave	<input type="checkbox"/>	<input type="checkbox"/>	<input checked="" type="checkbox"/>	<input type="checkbox"/>	Bathroom Vent Fan(s)
10						Built in (Circle One) <u>YES</u> NO	<input type="checkbox"/>	<input type="checkbox"/>	<input checked="" type="checkbox"/>	<input type="checkbox"/>	Telephone Wiring/Blocks/Jacks
11	<input type="checkbox"/>	<input type="checkbox"/>	<input checked="" type="checkbox"/>	<input type="checkbox"/>	<input type="checkbox"/>	Range Hood	<input type="checkbox"/>	<input type="checkbox"/>	<input checked="" type="checkbox"/>	<input type="checkbox"/>	Door Bell
12						Vented Outside (Circle One) YES <u>NO</u>	<input checked="" type="checkbox"/>	<input type="checkbox"/>	<input type="checkbox"/>	<input type="checkbox"/>	Intercom
13	<input type="checkbox"/>	<input type="checkbox"/>	<input checked="" type="checkbox"/>	<input type="checkbox"/>	<input type="checkbox"/>	Kitchen Refrigerator	<input type="checkbox"/>	<input type="checkbox"/>	<input checked="" type="checkbox"/>	<input type="checkbox"/>	Garage Door Opener
14	<input type="checkbox"/>	<input type="checkbox"/>	<input checked="" type="checkbox"/>	<input type="checkbox"/>	<input type="checkbox"/>	Clothes Washer	# of Remotes: <u>3</u>				Keypad Entry: (Circle One) <u>YES</u> NO
15	<input type="checkbox"/>	<input type="checkbox"/>	<input checked="" type="checkbox"/>	<input type="checkbox"/>	<input type="checkbox"/>	Clothes Dryer	<input checked="" type="checkbox"/>	<input type="checkbox"/>	<input type="checkbox"/>	<input type="checkbox"/>	Aluminum Wiring
16	<input checked="" type="checkbox"/>	<input type="checkbox"/>	<input type="checkbox"/>	<input type="checkbox"/>	<input type="checkbox"/>	Trash Compactor	<input type="checkbox"/>	<input type="checkbox"/>	<input checked="" type="checkbox"/>	<input type="checkbox"/>	Copper Wiring
17	<input checked="" type="checkbox"/>	<input type="checkbox"/>	<input type="checkbox"/>	<input type="checkbox"/>	<input type="checkbox"/>	Central Vacuum	<input type="checkbox"/>	<input type="checkbox"/>	<input checked="" type="checkbox"/>	<input type="checkbox"/>	220 Volt
18	<input checked="" type="checkbox"/>	<input type="checkbox"/>	<input type="checkbox"/>	<input type="checkbox"/>	<input type="checkbox"/>	Exterior Attached Gas Grill	<u>200</u>				Service Panel Total Amps
19	<input type="checkbox"/>	<input type="checkbox"/>	<input type="checkbox"/>	<input type="checkbox"/>	<input type="checkbox"/>	Other: _____	<input type="checkbox"/>	<input checked="" type="checkbox"/>	<input type="checkbox"/>	<input type="checkbox"/>	Security System
20	<input type="checkbox"/>	<input type="checkbox"/>	<input type="checkbox"/>	<input type="checkbox"/>	<input type="checkbox"/>	Other: _____					(Circle One) Own Rent/ <u>Financed</u>
21	<input type="checkbox"/>	<input type="checkbox"/>	<input type="checkbox"/>	<input type="checkbox"/>	<input type="checkbox"/>	Other: _____	<u>VINCENT</u>				Company
22	<input type="checkbox"/>	<input type="checkbox"/>	<input type="checkbox"/>	<input type="checkbox"/>	<input type="checkbox"/>	Other: _____	<input checked="" type="checkbox"/>	<input type="checkbox"/>	<input type="checkbox"/>	<input type="checkbox"/>	Audio/Video Surveillance System
23	Comments:					Comments:					

26 WATER/SEWAGE SYSTEMS (See Part II Also)					HEATING & COOLING SYSTEMS					
		TRANSFERS TO BUYER			Indicate the condition of the following items by marking only one appropriate box.			TRANSFERS TO BUYER		
None		Working	Not Working	Don't Know		None		Working	Not Working	Don't Know
Does Not Transfer						Does Not Transfer				
27										
28										
29	<input type="checkbox"/>	<input type="checkbox"/>	<input type="checkbox"/>	<input type="checkbox"/>	Sewage Systems	<input type="checkbox"/>	<input type="checkbox"/>	<input type="checkbox"/>	<input type="checkbox"/>	Cooling System
30	<input type="checkbox"/>	<input type="checkbox"/>	<input type="checkbox"/>	<input type="checkbox"/>	Sump Pump					Type
31	<input type="checkbox"/>	<input type="checkbox"/>	<input type="checkbox"/>	<input type="checkbox"/>	Backup Sump Pump/Battery					Age
32	<input type="checkbox"/>	<input type="checkbox"/>	<input type="checkbox"/>	<input type="checkbox"/>	Plumbing	<input type="checkbox"/>	<input type="checkbox"/>	<input type="checkbox"/>	<input type="checkbox"/>	Heating System
33					Type					Type
34	<input type="checkbox"/>	<input type="checkbox"/>	<input type="checkbox"/>	<input type="checkbox"/>	Water Heater (Circle One) Elect Gas					Age
35					Size & Age	<input type="checkbox"/>	<input type="checkbox"/>	<input type="checkbox"/>	<input type="checkbox"/>	Window/Wall Air Conditioning Units
36	<input type="checkbox"/>	<input type="checkbox"/>	<input type="checkbox"/>	<input type="checkbox"/>	Instant Hot Water	<input type="checkbox"/>	<input type="checkbox"/>	<input type="checkbox"/>	<input type="checkbox"/>	Electronic Air Filter
37	<input type="checkbox"/>	<input type="checkbox"/>	<input type="checkbox"/>	<input type="checkbox"/>	Water Softener	<input type="checkbox"/>	<input type="checkbox"/>	<input type="checkbox"/>	<input type="checkbox"/>	Humidifier
38					(Circle One) Own Rent/Lease	<input type="checkbox"/>	<input type="checkbox"/>	<input type="checkbox"/>	<input type="checkbox"/>	Fireplace
39					Company	<input type="checkbox"/>	<input type="checkbox"/>	<input type="checkbox"/>	<input type="checkbox"/>	Fireplace Insert
40	<input type="checkbox"/>	<input type="checkbox"/>	<input type="checkbox"/>	<input type="checkbox"/>	Water Purifier/Reverse Osmosis	<input type="checkbox"/>	<input type="checkbox"/>	<input type="checkbox"/>	<input type="checkbox"/>	Wood burning Stove
41	<input type="checkbox"/>	<input type="checkbox"/>	<input type="checkbox"/>	<input type="checkbox"/>	Underground Sprinkler System					Chimney/Flue - Date Last Cleaned
42					Backflow Device (Circle One) YES NO	<input type="checkbox"/>	<input type="checkbox"/>	<input type="checkbox"/>	<input type="checkbox"/>	Gas Log Lighter
43					Date Last Tested or Inspected	<input type="checkbox"/>	<input type="checkbox"/>	<input type="checkbox"/>	<input type="checkbox"/>	Whole House Attic Fan
44	<input type="checkbox"/>	<input type="checkbox"/>	<input type="checkbox"/>	<input type="checkbox"/>	Pool Equipment	<input type="checkbox"/>	<input type="checkbox"/>	<input type="checkbox"/>	<input type="checkbox"/>	Solar Equipment
45	<input type="checkbox"/>	<input type="checkbox"/>	<input type="checkbox"/>	<input type="checkbox"/>	Hot Tub/Spa	<input type="checkbox"/>	<input type="checkbox"/>	<input type="checkbox"/>	<input type="checkbox"/>	Propane Tank
46	Comments:									(Circle One) Own Rent/Lease
47										Company
48	<b>MEDIA</b>					Comments:				
49						Any Additional Comments For Part I:				
50										
51	<input type="checkbox"/>	<input type="checkbox"/>	<input type="checkbox"/>	<input type="checkbox"/>	Satellite Dish					
52	<input type="checkbox"/>	<input type="checkbox"/>	<input type="checkbox"/>	<input type="checkbox"/>	# of Rcvrs/Remotes					
53	<input type="checkbox"/>	<input type="checkbox"/>	<input type="checkbox"/>	<input type="checkbox"/>	Attached Antennaes					
54	<input type="checkbox"/>	<input type="checkbox"/>	<input type="checkbox"/>	<input type="checkbox"/>	Cable TV Wiring/Jacks					
55	<input type="checkbox"/>	<input type="checkbox"/>	<input type="checkbox"/>	<input type="checkbox"/>	Attached Television Mount(s)					
56	<input type="checkbox"/>	<input type="checkbox"/>	<input type="checkbox"/>	<input type="checkbox"/>	Projector(s)					
57	<input type="checkbox"/>	<input type="checkbox"/>	<input type="checkbox"/>	<input type="checkbox"/>	Projector Screen(s)					
58	<input type="checkbox"/>	<input type="checkbox"/>	<input type="checkbox"/>	<input type="checkbox"/>	Surround Sound Speakers					
59	<input type="checkbox"/>	<input type="checkbox"/>	<input type="checkbox"/>	<input type="checkbox"/>	Wired for Surround Sound					
60	Comments:									
61										
62										

**PART II**

Answer each question with one answer to the best of your knowledge. Specify relevant details in Additional Comment lines.

Attach all relevant documentation for further explanation, including any and all repair reports.

YES	NO	DON'T KNOW	SECTION 1 <b>STRUCTURAL FOUNDATION/WALLS</b>
<input type="checkbox"/>	<input type="checkbox"/>	<input type="checkbox"/>	Are any exterior walls covered with Exterior Insulation & Finish System (synthetic stucco)? If YES, are you aware of any adverse conditions? _____
			Indicate all that apply: <input type="checkbox"/> Basement <input type="checkbox"/> Crawl Space <input type="checkbox"/> Slab
<input type="checkbox"/>	<input type="checkbox"/>	<input type="checkbox"/>	Are there any structural engineer's report(s) available? If YES, Date of Report: _____ Copy Attached? (Mark One): <input type="checkbox"/> YES <input type="checkbox"/> NO
<b>To your knowledge, indicate any past or present: (Use Comment Lines for further explanations)</b>			
<input type="checkbox"/>	<input type="checkbox"/>	<input type="checkbox"/>	Movement, shifting, deterioration or other problems with walls or foundation?
<input type="checkbox"/>	<input type="checkbox"/>	<input type="checkbox"/>	Cracks or flaws in the walls, floors or foundation?
<input type="checkbox"/>	<input type="checkbox"/>	<input type="checkbox"/>	Problems with driveways, walkways, patios, retaining walls, party walls?
<input type="checkbox"/>	<input type="checkbox"/>	<input type="checkbox"/>	Problems with operation of windows or doors, or broken seals?
<input type="checkbox"/>	<input type="checkbox"/>	<input type="checkbox"/>	Any corrective actions to items in this section? (Example - Piering, bracing, etc.)
<input type="checkbox"/>	<input type="checkbox"/>	<input type="checkbox"/>	Are there any transferable warranties?    Date: _____ (If YES, explain below and attach copy.)
<input type="checkbox"/>	<input type="checkbox"/>	<input type="checkbox"/>	Is there insulation in the walls?
<input type="checkbox"/>	<input type="checkbox"/>	<input type="checkbox"/>	Is there insulation in the floors?
Additional Comments: _____			

YES	NO	DON'T KNOW	SECTION 2 <b>ROOF/INSULATION</b>
			Age: _____ Type: _____
<input type="checkbox"/>	<input type="checkbox"/>	<input type="checkbox"/>	To your knowledge, are there any <input type="checkbox"/> PAST <input type="checkbox"/> PRESENT    roof leaks?                    (Mark One) If any, identify details below.
<input type="checkbox"/>	<input type="checkbox"/>	<input type="checkbox"/>	During your ownership, has the roof ever been <input type="checkbox"/> REPLACED? <input type="checkbox"/> REPAIRED?                    (Mark One) If YES, Date: _____ (Identify details below.)
<input type="checkbox"/>	<input type="checkbox"/>	<input type="checkbox"/>	Are there any transferable warranties?    Date: _____ (If YES, explain below and attach copy.)
<input type="checkbox"/>	<input type="checkbox"/>	<input type="checkbox"/>	Do you know of any problems with chimneys or chases? (If YES, explain below.)
<input type="checkbox"/>	<input type="checkbox"/>	<input type="checkbox"/>	Do you know of any problems with roof, roof structure or rain gutters? (If YES, explain below.)
<input type="checkbox"/>	<input type="checkbox"/>	<input type="checkbox"/>	Is there insulation in the ceiling/attic?
Additional Comments: _____			

YES	NO	DON'T KNOW	SECTION 3 <b>MOLD/MILDEW</b>
According to the EPA, molds are part of the natural environment. Molds reproduce by means of tiny spores that are invisible to the naked eye, and float through outdoor and indoor air. Mold may begin growing indoors when mold spores land on surfaces that are wet. Inhaling or touching mold spores may cause allergic reactions in sensitive individuals.			
<b>To your knowledge, indicate any past or present: (Use Comment Lines for further explanations)</b>			
<input type="checkbox"/>	<input type="checkbox"/>	<input type="checkbox"/>	Presence of any mold/mildew in the property?
<input type="checkbox"/>	<input type="checkbox"/>	<input type="checkbox"/>	Any problems created by mold or mildew for occupants of the structure during your ownership?
<input type="checkbox"/>	<input type="checkbox"/>	<input type="checkbox"/>	Have you had any inspections for mold or mildew?                    If YES, Date: _____ (If YES, explain below.)
<input type="checkbox"/>	<input type="checkbox"/>	<input type="checkbox"/>	Have you received any reports pertaining to mold or mildew on or within the structure? (If YES, attach.)
<input type="checkbox"/>	<input type="checkbox"/>	<input type="checkbox"/>	Has the property had any professional mold remediation during your ownership? If YES, Date: _____
Additional Comments: _____			



117 Answer each question with one answer to the best of your knowledge. Specify relevant details in Additional Comment lines.  
 118 Attach all relevant documentation for further explanation, including any and all repair reports.  
 119

YES	NO	DON'T KNOW	SECTION 4 WATER/SEWAGE SYSTEMS	
<input type="checkbox"/>	<input type="checkbox"/>	<input type="checkbox"/>	Is the property connected to City Water?	
<input type="checkbox"/>	<input type="checkbox"/>	<input type="checkbox"/>	Is the property connected to Rural Water? If YES, Transfer Fee: _____ District: _____	
<input type="checkbox"/>	<input type="checkbox"/>	<input type="checkbox"/>	Is the property connected to any private water systems? (Mark all that apply.)	
			<input type="checkbox"/> Drinking Well	<input type="checkbox"/> Irrigation Well
<input type="checkbox"/>	<input type="checkbox"/>	<input type="checkbox"/>	Working? Type: _____ Location: _____	<input type="checkbox"/> Geo-Thermal Well
<input type="checkbox"/>	<input type="checkbox"/>	<input type="checkbox"/>	Working? Type: _____ Location: _____	Depth: _____
<input type="checkbox"/>	<input type="checkbox"/>	<input type="checkbox"/>	Working? Type: _____ Location: _____	Depth: _____
<input type="checkbox"/>	<input type="checkbox"/>	<input type="checkbox"/>	Has the water in any wells shown test results of contamination? (If YES, explain below.)	
<input type="checkbox"/>	<input type="checkbox"/>	<input type="checkbox"/>	Is the property connected to a public sewer system? If shared lagoon/septic system, explain below.	
<input type="checkbox"/>	<input type="checkbox"/>	<input type="checkbox"/>	Is the property connected to a septic system? Date Last Pumped: _____	
			Tank Size: _____ Location: _____	
			# feet laterals: _____ # Feet infiltrators: _____ Location: _____	
<input type="checkbox"/>	<input type="checkbox"/>	<input type="checkbox"/>	Is the property connected to a lagoon system? Location: _____	
<input type="checkbox"/>	<input type="checkbox"/>	<input type="checkbox"/>	Is the property connected to some other type of waste disposal system? (If YES, explain below.)	
<input type="checkbox"/>	<input type="checkbox"/>	<input type="checkbox"/>	Has the main waste disposal line ever been snaked or scoped?	
<input type="checkbox"/>	<input type="checkbox"/>	<input type="checkbox"/>	To your knowledge, is there any problem relating to the waste disposal system?	
Additional Comments:				

YES	NO	DON'T KNOW	SECTION 5 WATER INTRUSION/LEAKS	
<i>To your knowledge, indicate any past or present: (Use Comment Lines for further explanations)</i>				
<input type="checkbox"/>	<input type="checkbox"/>	<input type="checkbox"/>	Any water leakage in or around the fireplace or chimney?	
<input type="checkbox"/>	<input type="checkbox"/>	<input type="checkbox"/>	Any water leakage around (If YES, mark all that apply.) <input type="checkbox"/> WINDOWS <input type="checkbox"/> SKYLIGHTS <input type="checkbox"/> DOORS?	
<input type="checkbox"/>	<input type="checkbox"/>	<input type="checkbox"/>	Any leaks occurring in any plumbing, water supply lines, drains, sewer lines, etc.?	
<input type="checkbox"/>	<input type="checkbox"/>	<input type="checkbox"/>	Any leaks caused by appliances?	
<input type="checkbox"/>	<input type="checkbox"/>	<input type="checkbox"/>	Any leaks from any condensation drain lines, humidifier, dehumidifier, etc.?	
<input type="checkbox"/>	<input type="checkbox"/>	<input type="checkbox"/>	Any water leakage into (If YES, mark all that apply.) <input type="checkbox"/> BASEMENT <input type="checkbox"/> CRAWL SPACE	
<input type="checkbox"/>	<input type="checkbox"/>	<input type="checkbox"/>	Any accumulation of water within the basement/crawl space?	
<input type="checkbox"/>	<input type="checkbox"/>	<input type="checkbox"/>	Sump Pump(s) Location(s): _____	
<input type="checkbox"/>	<input type="checkbox"/>	<input type="checkbox"/>	Drain Tiles (If YES, mark all that apply.) <input type="checkbox"/> INTERIOR <input type="checkbox"/> EXTERIOR	
Additional Comments:				

YES	NO	DON'T KNOW	SECTION 6 PEST, WOOD INFESTATION & DRY ROT	
<input type="checkbox"/>	<input type="checkbox"/>	<input type="checkbox"/>	Do you have any knowledge of the following items on/affecting the property? (Mark all that apply.)	
			<input type="checkbox"/> WOOD DESTROYING INSECTS	<input type="checkbox"/> DRY ROT
			<input type="checkbox"/> OTHER WOOD INFESTATION	
<input type="checkbox"/>	<input type="checkbox"/>	<input type="checkbox"/>	Any knowledge of any damage to the property caused by the following items? (Mark all that apply.)	
			<input type="checkbox"/> WOOD DESTROYING INSECTS	<input type="checkbox"/> DRY ROT
			<input type="checkbox"/> OTHER WOOD INFESTATION	
<input type="checkbox"/>	<input type="checkbox"/>	<input type="checkbox"/>	Have there been any repairs of such damage? (If YES, explain below.)	
<input type="checkbox"/>	<input type="checkbox"/>	<input type="checkbox"/>	Is the property currently under a termite warranty or other coverage by a licensed pest control company?	
			Company: _____	Warranty Expiration Date: _____
<input type="checkbox"/>	<input type="checkbox"/>	<input type="checkbox"/>	Any wood destroying insects control reports in the last 5 years? (If YES, explain below.)	
<input type="checkbox"/>	<input type="checkbox"/>	<input type="checkbox"/>	Any professional wood destroying insects control treatments in the last 5 years? (If YES, explain below.)	
<input type="checkbox"/>	<input type="checkbox"/>	<input type="checkbox"/>	Any pest control reports in the last 5 years? (If YES, explain below.)	
<input type="checkbox"/>	<input type="checkbox"/>	<input type="checkbox"/>	Any professional pest control treatments in the last 5 years? (If YES, explain below.)	
Additional Comments:				

172 Answer each question with one answer to the best of your knowledge. Specify relevant details in Additional Comment lines.  
 173 Attach all relevant documentation for further explanation, including any and all repair reports.  
 174

			SECTION 7
			ENVIRONMENTAL CONDITIONS
YES	NO	DON'T KNOW	
<input type="checkbox"/>	<input type="checkbox"/>	<input type="checkbox"/>	Is the property located in a subdivision with a master drainage plan?
<input type="checkbox"/>	<input type="checkbox"/>	<input type="checkbox"/>	If YES, is the property in compliance?
<input type="checkbox"/>	<input type="checkbox"/>	<input type="checkbox"/>	Has the property ever had any drainage problems during your ownership? (If YES, explain below.)
<input type="checkbox"/>	<input type="checkbox"/>	<input type="checkbox"/>	Are there any producing or non-producing gas/oil wells on the property or adjacent property?
<input type="checkbox"/>	<input type="checkbox"/>	<input type="checkbox"/>	Do mineral rights convey to buyer? If NO, please define: _____
			<b>Groundwater contamination has been detected in several areas in the State of Kansas.</b>
<input type="checkbox"/>	<input type="checkbox"/>	<input type="checkbox"/>	Are you aware of groundwater contamination or other environmental concerns?
<input type="checkbox"/>	<input type="checkbox"/>	<input type="checkbox"/>	Any reports or records pertaining to groundwater contamination or other environmental concerns?
<input type="checkbox"/>	<input type="checkbox"/>	<input type="checkbox"/>	Are there any diseased or dead trees and shrubs?
<i>To your knowledge, are any of the following substances, materials, products on the real property? (YES or NO Only.)</i>			
<input type="checkbox"/>	<input type="checkbox"/>	<input type="checkbox"/>	Asbestos
<input type="checkbox"/>	<input type="checkbox"/>	<input type="checkbox"/>	Contaminated soil or water (including drinking water)
<input type="checkbox"/>	<input type="checkbox"/>	<input type="checkbox"/>	Landfill or buried materials
<input type="checkbox"/>	<input type="checkbox"/>	<input type="checkbox"/>	Lead-based paint (If YES, attach disclosure.)
<input type="checkbox"/>	<input type="checkbox"/>	<input type="checkbox"/>	Radon gas in house or well      Has a mitigation system been installed? (Mark One) <input type="checkbox"/> YES <input type="checkbox"/> NO
<input type="checkbox"/>	<input type="checkbox"/>	<input type="checkbox"/>	Methane Gas
<input type="checkbox"/>	<input type="checkbox"/>	<input type="checkbox"/>	Oil sheers in wet areas
<input type="checkbox"/>	<input type="checkbox"/>	<input type="checkbox"/>	Radioactive material
<input type="checkbox"/>	<input type="checkbox"/>	<input type="checkbox"/>	Toxic material disposal (solvents, chemicals, etc.)
<input type="checkbox"/>	<input type="checkbox"/>	<input type="checkbox"/>	Underground fuel or chemical storage tanks
<input type="checkbox"/>	<input type="checkbox"/>	<input type="checkbox"/>	EMFs (Electro Magnetic Fields)
<input type="checkbox"/>	<input type="checkbox"/>	<input type="checkbox"/>	Urea formaldehyde foam insulation (UFFI)
<input type="checkbox"/>	<input type="checkbox"/>	<input type="checkbox"/>	Other: _____
<input type="checkbox"/>	<input type="checkbox"/>	<input type="checkbox"/>	Are you aware if any portion of the property has ever been used for the manufacture of, or storage of, chemicals or equipment used in manufacturing methamphetamine, ecstasy, LSD or any other illegal substances?
<input type="checkbox"/>	<input type="checkbox"/>	<input type="checkbox"/>	To your knowledge, are any of the above conditions present <b>near</b> your property?
Comments:			

			SECTION 8
			BOUNDARIES/LAND
YES	NO	DON'T KNOW	
<input type="checkbox"/>	<input type="checkbox"/>	<input type="checkbox"/>	Have you had a survey of the property? (If YES, attach copy if available.)
<input type="checkbox"/>	<input type="checkbox"/>	<input type="checkbox"/>	Are the boundaries of your property marked in any way?
<input type="checkbox"/>	<input type="checkbox"/>	<input type="checkbox"/>	Is there any fencing on the boundaries of the property?
<input type="checkbox"/>	<input type="checkbox"/>	<input type="checkbox"/>	Does fencing belong to the property? If YES, which sides? _____
<input type="checkbox"/>	<input type="checkbox"/>	<input type="checkbox"/>	Are there any features of the property shared in common with adjoining landowners, such as, walls, fences, roads, driveways? (If YES, explain below.)
<input type="checkbox"/>	<input type="checkbox"/>	<input type="checkbox"/>	Is the property owner responsible for maintenance of any such shared feature(s)?
<input type="checkbox"/>	<input type="checkbox"/>	<input type="checkbox"/>	To your knowledge, are there any boundary disputes, encroachments, or unrecorded easements?
<input type="checkbox"/>	<input type="checkbox"/>	<input type="checkbox"/>	To your knowledge, is any portion of the property located in a federally designated flood plain?
<input type="checkbox"/>	<input type="checkbox"/>	<input type="checkbox"/>	Do you currently, or have you ever, paid flood insurance for the property?
<input type="checkbox"/>	<input type="checkbox"/>	<input type="checkbox"/>	To your knowledge, is any portion of the property located in a designated wetlands area?
<input type="checkbox"/>	<input type="checkbox"/>	<input type="checkbox"/>	Do you know of any of the following items that have occurred on the property or in the immediate area? (Mark all that apply.)
			<input type="checkbox"/> EXPANSIVE SOIL
			<input type="checkbox"/> EARTH MOVEMENT
			<input type="checkbox"/> FILL DIRT
			<input type="checkbox"/> UPHEAVAL
			<input type="checkbox"/> SLIDING
			<input type="checkbox"/> EARTH STABILITY PROBLEMS
			<input type="checkbox"/> SETTLING
Comments:			

228 Answer each question with one answer to the best of your knowledge. Specify relevant details in Additional Comment lines.  
 229 Attach all relevant documentation for further explanation, including any and all repair reports.

YES	NO	DON'T KNOW	SECTION 9 <b>SPECIAL ASSESSMENTS AND HOMEOWNER'S ASSOCIATION</b>
<b>The law requires that the Seller disclose the existence of special assessments against a property.</b>			
<input type="checkbox"/>	<input type="checkbox"/>	<input type="checkbox"/>	Any current/pending bonds, assessments, or special taxes that apply to property?
<input type="checkbox"/>	<input type="checkbox"/>	<input type="checkbox"/>	The property may be subject to special assessments or is located in an improvement district? (Refer to relevant tax disclosure - Mark One). <div style="text-align: center;"> <input type="checkbox"/> Owner                      <input type="checkbox"/> County                      <input type="checkbox"/> Public Record                      <input type="checkbox"/> Other:         </div>
<input type="checkbox"/>	<input type="checkbox"/>	<input type="checkbox"/>	Is the property subject to rules or regulations of an active Homeowner's Association? Annual Dues? _____ Initiation Fee? _____
<input type="checkbox"/>	<input type="checkbox"/>	<input type="checkbox"/>	Homeowner's Association contact information: _____
<input type="checkbox"/>	<input type="checkbox"/>	<input type="checkbox"/>	Is the property subject to a right of first refusal?
<input type="checkbox"/>	<input type="checkbox"/>	<input type="checkbox"/>	Is the property subject to covenants, conditions, and restrictions of a Homeowner's Association or subdivision restrictions?
<input type="checkbox"/>	<input type="checkbox"/>	<input type="checkbox"/>	Any violations of such covenants and restrictions?
Comments:			

YES	NO	DON'T KNOW	SECTION 10 <b>MISCELLANEOUS</b>
<input type="checkbox"/>	<input type="checkbox"/>	<input type="checkbox"/>	Have any improvements or repairs (including, but not limited to, HVAC, plumbing, electrical, structural additions) been made to the property <b>without obtaining required permits</b> ?
<input type="checkbox"/>	<input type="checkbox"/>	<input type="checkbox"/>	Are any local, state, or federal agencies requiring repairs, alterations, or corrections of any existing conditions?
<input type="checkbox"/>	<input type="checkbox"/>	<input type="checkbox"/>	Is the present use of the property a non-conforming use?
<input type="checkbox"/>	<input type="checkbox"/>	<input type="checkbox"/>	Have there been any insurance claims during the seller's ownership? Were repairs made? If so, explain: _____
<input type="checkbox"/>	<input type="checkbox"/>	<input type="checkbox"/>	Is there any unrepaired damage due to hail, storm, wind, fire or flood?
<input type="checkbox"/>	<input type="checkbox"/>	<input type="checkbox"/>	Are there any stains, tears, burns, holes, etc., in the property that are not readily visible?
<input type="checkbox"/>	<input type="checkbox"/>	<input type="checkbox"/>	Does a pet(s) reside or has a pet(s) ever resided in or on the property?
<input type="checkbox"/>	<input type="checkbox"/>	<input type="checkbox"/>	Is there any damage due to pets, interior/exterior, including, but not limited to, odors, stains, etc.?
<input type="checkbox"/>	<input type="checkbox"/>	<input type="checkbox"/>	Do all window and door treatments remain? If NO, please list: _____
<input type="checkbox"/>	<input type="checkbox"/>	<input type="checkbox"/>	Does any other personal property remain? If YES, please list: _____
<input type="checkbox"/>	<input type="checkbox"/>	<input type="checkbox"/>	Does the property contain any of the following? (Mark all that apply.) <input type="checkbox"/> Swimming Pool <input type="checkbox"/> Spa <input type="checkbox"/> Hot Tub <input type="checkbox"/> Sauna <input type="checkbox"/> Water Feature
<input type="checkbox"/>	<input type="checkbox"/>	<input type="checkbox"/>	If YES, are either of the following heated? <input type="checkbox"/> Swimming Pool <input type="checkbox"/> Spa If yes, type of heat? _____
<input type="checkbox"/>	<input type="checkbox"/>	<input type="checkbox"/>	Are you aware of any past or present problems relating to the swimming pool, spa, hot tub, sauna or water feature? Explain: _____
<input type="checkbox"/>	<input type="checkbox"/>	<input type="checkbox"/>	Is the property in a holistic, conservation or special review district, that requires any alterations or improvements to the Property, be approved by a board or commission?
<input type="checkbox"/>	<input type="checkbox"/>	<input type="checkbox"/>	Are there any other facts, conditions, or circumstances, on or off site, which could affect the value, beneficial use, or desirability of the property?
<input type="checkbox"/>	<input type="checkbox"/>	<input type="checkbox"/>	Are there any transferable warranties on the property or any of its components?
Comments:			

272 **Any Additional Comments For Part II:**

273 \_\_\_\_\_

274 \_\_\_\_\_

275 \_\_\_\_\_

276 \_\_\_\_\_

277 \_\_\_\_\_

279

### SELLER'S ACKNOWLEDGEMENT

280 Seller acknowledges that: the information contained in this disclosure is accurate, true and complete to the best  
281 of Seller's knowledge, information and belief; Seller has provided all the information contained in this Seller's  
282 Property Disclosure; and that the Broker/Realtor® has not prepared, nor assisted in the preparation of this  
283 Disclosure. Seller hereby indemnifies, holds harmless and releases all Brokers/Realtors® involved in the sale of  
284 the property from all liability, claims, loss, cost, or damage in connection with the information contained in this  
285 Disclosure. Seller hereby authorizes the listing broker to provide copies of this Disclosure to other real estate  
286 brokers and agents and prospective buyers of the property.

287  
288 Seller is occupant:  YES  NO  
289

290 Seller certifies that the information herein is true and correct to the best of the Seller's knowledge as of the date  
291 signed by Seller.

292 SELLER: [Signature] 6/30/21 SELLER: [Signature] 6/30/21  
293 Date Date

294

### BUYER'S ACKNOWLEDGEMENT AND AGREEMENT

- 295 1. I have personally inspected the property. I have been advised to have the property examined by professional  
296 inspectors. Subject to any inspections, I agree to purchase the property in its present condition without  
297 representations or guarantees of any kind by the Seller or any REALTORS® concerning the condition or value of  
298 the property, except as given above or as stated in my contract with the Seller.
- 299 2. I acknowledge that neither Seller nor any REALTORS® involved in this transaction is an expert at detecting or  
300 repairing physical defects in the property.
- 301 3. I acknowledge that I have been informed that Kansas Law requires persons who are convicted of certain  
302 sexually violent crimes after April 14, 1994, to register with the sheriff of the county in which they reside. I have  
303 been advised that if I desire information regarding those registrants, I may find information on the home page of  
304 the Kansas Bureau of Investigation (KBI) at <http://www.kansas.gov/kbi/> or by contacting the local sheriff's office.
- 305 4. I acknowledge that McConnell Air Force Base is located within Sedgwick County and is an operational military  
306 Air Force base that is open 24 hours a day and activity at that base may generate noise. The volume, pitch,  
307 amount and frequency of noise may be affected by future changes in McConnell Air Force Base activity. I have  
308 been informed that if I desire information regarding potential for noise caused by the aircraft operations  
309 associated with McConnell Air Force Base and its operations, I may find information by contacting the  
310 Metropolitan Area Planning Department.

311 BUYER: \_\_\_\_\_ BUYER: \_\_\_\_\_  
312 Date Date

This form is approved by legal counsel for the REALTORS® of South Central Kansas exclusively for use by members of the REALTORS® of South Central Kansas and other authorized REALTORS®. No warranty is made or implied as to the legal validity or adequacy of this form, or that its use is appropriate for all situations. Copyright 2019.

**Summary**

Tax ID FORT00035  
 Tax Year 2020  
 Name FORTON, EDWARD J  
 Property Address 801 FOOTHILL  
 Sec-Twp-Rng 30--2-05  
 Description  
 Parcel ID/Cama 0293003007005000  
 Parcel Classes RL  
 Tax Unit 9

*Edw J Forton*  
*Marci Lynn Forton*

**Tax History**

Tax Year	Assessed Valuation	Miil Levy	Ad Valorem	Special Assessments	Total Tax	Total Paid	DIQ
2020	\$0	0.000	\$0.00	\$0.00	\$3,586.82	\$3,586.82	N
2020	\$0	0.000	\$0.00	\$765,984.00	\$96.00	\$96.00	N
2019	\$0	0.000	\$0.00	\$766,080.00	\$96.00	\$96.00	N
2019	\$0	0.000	\$0.00	\$0.00	\$3,534.40	\$3,534.40	N
2018	\$0	0.000	\$0.00	\$0.00	\$3,367.02	\$3,367.02	N
2018	\$0	0.000	\$0.00	\$734,252.00	\$92.00	\$92.00	N
2017	\$0	0.000	\$0.00	\$0.00	\$3,285.08	\$3,285.08	N
2017	\$0	0.000	\$0.00	\$686,452.00	\$86.00	\$86.00	N
2016	\$0	0.000	\$0.00	\$0.00	\$3,275.98	\$3,275.98	N
2016	\$0	0.000	\$0.00	\$720.00	\$80.00	\$80.00	N
2015	\$0	0.000	\$0.00	\$0.00	\$3,344.14	\$3,344.14	N
2015	\$0	0.000	\$0.00	\$707.50	\$70.75	\$70.75	N
2014	\$0	0.000	\$0.00	\$0.00	\$3,375.90	\$3,375.90	N
2014	\$0	0.000	\$0.00	\$770.00	\$70.00	\$70.00	N
2013	\$0	0.000	\$0.00	\$0.00	\$3,121.86	\$3,121.86	N
2013	\$0	0.000	\$0.00	\$804.00	\$67.00	\$67.00	N
2012	\$0	0.000	\$0.00	\$871.00	\$67.00	\$67.00	N
2012	\$0	0.000	\$0.00	\$0.00	\$2,944.50	\$2,944.50	N
2011	\$0	0.000	\$0.00	\$0.00	\$3,001.46	\$3,001.46	N
2011	\$0	0.000	\$0.00	\$910.00	\$65.00	\$65.00	N
2010	\$0	0.000	\$0.00	\$0.00	\$3,029.04	\$3,029.04	N
2010	\$0	0.000	\$0.00	\$937.50	\$62.50	\$62.50	N
2009	\$0	0.000	\$0.00	\$0.00	\$2,997.78	\$2,997.78	N
2009	\$0	0.000	\$0.00	\$31.25	\$62.50	\$62.50	N
2008	\$0	0.000	\$0.00	\$31.25	\$62.50	\$62.50	N
2008	\$0	0.000	\$0.00	\$0.00	\$2,870.22	\$2,870.22	N
2007	\$0	0.000	\$0.00	\$0.00	\$2,744.42	\$2,744.42	N
2007	\$0	0.000	\$0.00	\$31.25	\$62.50	\$62.50	N
2006	\$0	0.000	\$0.00	\$31.25	\$62.50	\$62.50	N
2006	\$0	0.000	\$0.00	\$0.00	\$2,557.92	\$2,557.92	N
2005	\$0	0.000	\$0.00	\$0.00	\$2,510.20	\$2,510.20	N
2005	\$0	0.000	\$0.00	\$31.25	\$62.50	\$62.50	N
2004	\$0	0.000	\$0.00	\$31.25	\$62.50	\$62.50	N
2004	\$0	0.000	\$0.00	\$0.00	\$2,442.28	\$2,442.28	N
2003	\$0	0.000	\$0.00	\$31.25	\$62.50	\$62.50	N
2003	\$0	0.000	\$0.00	\$0.00	\$2,435.12	\$2,435.12	N
2002	\$0	0.000	\$0.00	\$0.00	\$2,375.32	\$2,375.32	N
2002	\$0	0.000	\$0.00	\$31.25	\$62.50	\$62.50	N
2001	\$0	0.000	\$0.00	\$0.00	\$2,295.04	\$2,295.04	N
2001	\$0	0.000	\$0.00	\$31.25	\$62.50	\$62.50	N
2000	\$0	0.000	\$0.00	\$31.25	\$62.50	\$62.50	N
2000	\$0	0.000	\$0.00	\$0.00	\$1,861.56	\$1,861.56	N
1999	\$0	0.000	\$0.00	\$30.00	\$60.00	\$60.00	N
1999	\$0	0.000	\$0.00	\$0.00	\$1,651.58	\$1,651.58	N
1998	\$0	0.000	\$0.00	\$27.50	\$55.00	\$55.00	N
1998	\$0	0.000	\$0.00	\$0.00	\$1,591.98	\$1,591.98	N
1997	\$0	0.000	\$0.00	\$0.00	\$1,527.40	\$1,527.40	N
1997	\$0	0.000	\$0.00	\$27.50	\$55.00	\$55.00	N





**Overview**

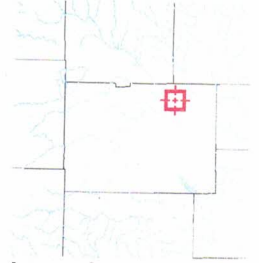

**Legend**

- Parcel Numbers
- Parcels
- Townships
- Flood Hazard Areas
  - Floodway
  - 1% Annual Chance Flood
  - 0.2% Annual Chanc Flood
- Road Centerline
- Reno County Boundary

Parcel ID	0293003007005000	Alternate ID	R2804	Owner Address	FORTON, EDWARD J & MARILYNN
Sec/Twp/Rng	30-22-05W	Class	R - Residential		801 FOOTHILL DR
Property Address	801 FOOTHILL DR	Acreege	n/a		HUTCHINSON, KS 67502
	Hutchinson				
District	009				
Brief Tax Description	FOOTHILL ESTATES, S30, T22, R05W, BLOCK E, Lot 4				
	(Note: Not to be used on legal documents)				

Date created: 6/29/2021  
 Last Data Uploaded: 6/28/2021 11:42:57 PM

Developed by Schneider  
 GEOSPATIAL